

CONS

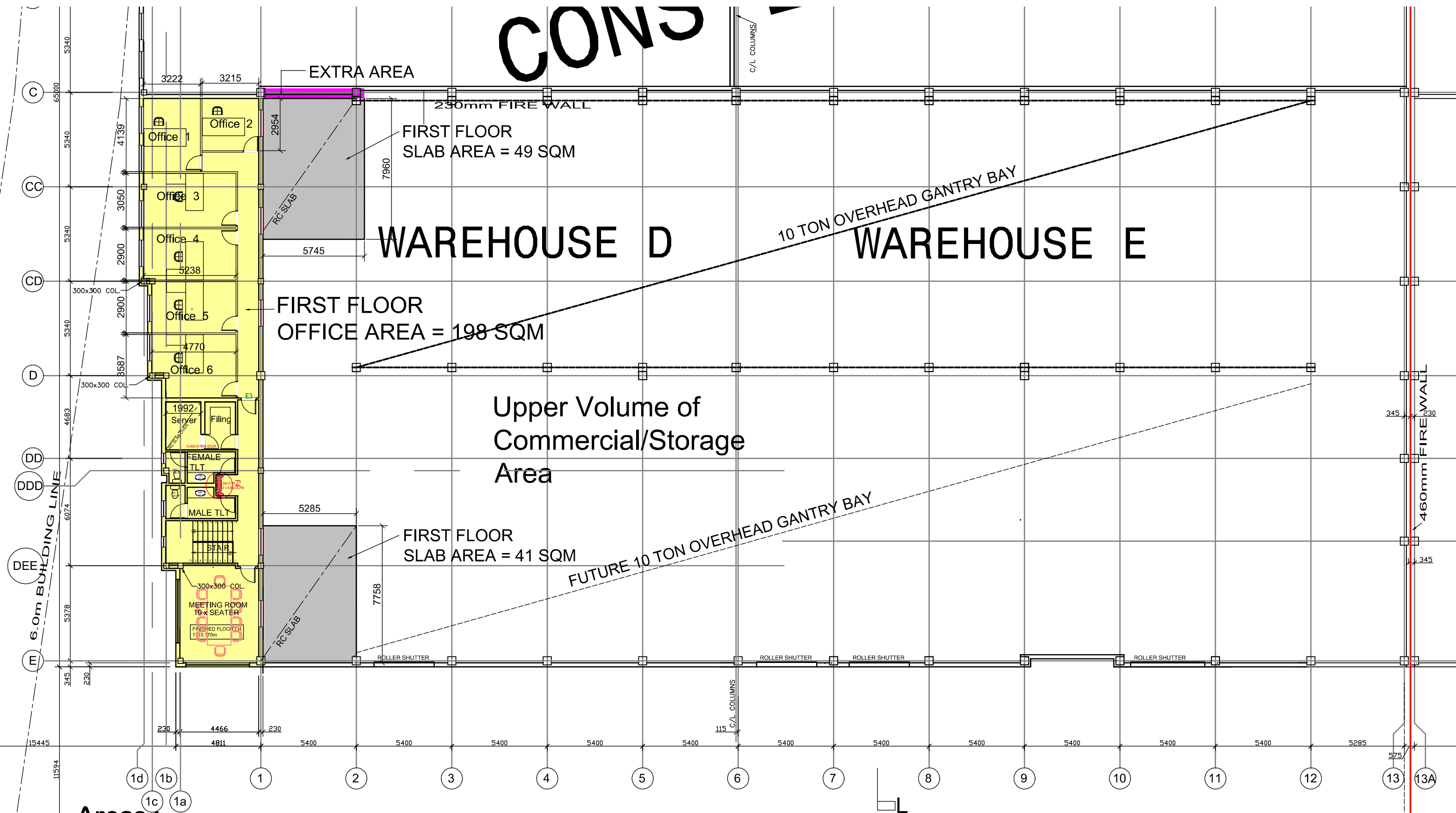

Areas:
 building footprint 2321 sqm
 grd flr offices 198 sqm
 grd flr warehouse 2123 sqm
 first floor offices 198 sqm
 Mezzanine slabs (49 + 41 = 90 sqm)

FIRST FLOOR PLAN 23 10 2017

UNIT D & E STORMILL EXT 5

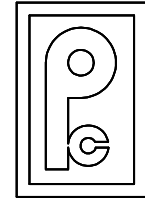

Paul Cawood Architect
 SACAP: Pr. Arch #4373
 4 Hillcrest Rd, Parkview
 Johannesburg
 011-486-4177
 083-414-0104
 fresh@global.co.za